



Valve Components		
A	600-664R	Actuating Knob (pkg of 2)
B	600-628R	Inlet O-Ring (pkg of 2)
C	AP600-666	Valve Stem with O-Rings and Spring
D	AP600-665	Diverter with O-Rings
E	450-005	Outlet Aerator Assembly

Inlet Adapters (included with unit)	
AP400-009	(1) 15/16"-27 Male Adapter with O-Ring, (1) 13/16"-27 Male Adapter with O-Ring, (1) 3/8" NPS Male Adapter with O-Ring (1) 13/16"-24 Female Adapter with O-Ring

Additional Adapters (ordered separately)	
AP400-015	(1) 3/4" Female Hose Adapter with O-Ring

G1100 Components		
A	250-046R	Dust Cover with Strap (pkg of 2)
B	AP450-110R	Aerator Assembly (pkg of 2)

G1101 Components		
A	250-046R	Dust Cover with Strap (pkg of 2)
B	AP450-110R	Aerator Assembly (pkg of 2)

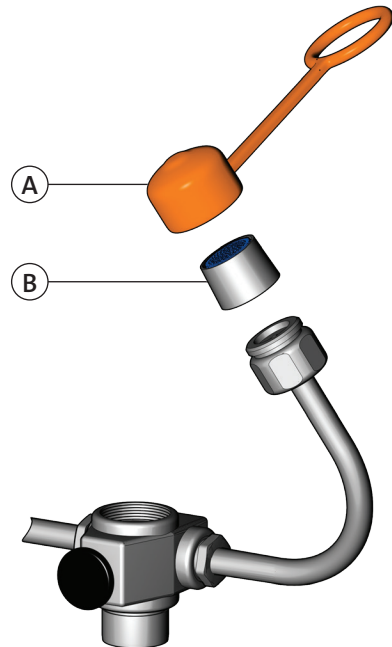
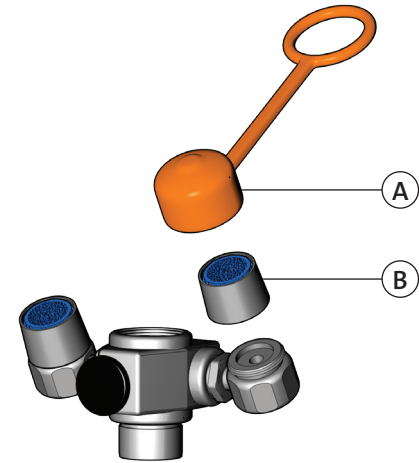
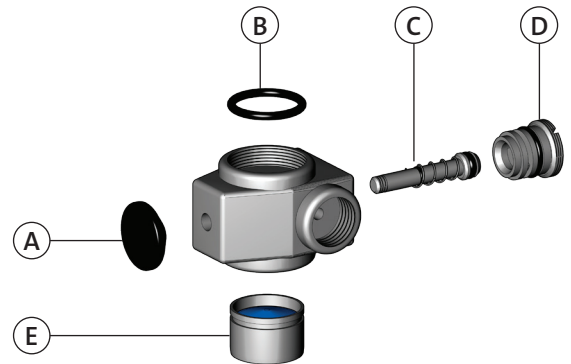



### Installation

1. Remove present aerator or other fitting from faucet outlet.
2. Mount the EyeSafe™ unit to faucet spout. The EyeSafe™ inlet has a 55/64"-27 female thread.

*Note: Due to the variety of faucets, it may be necessary to use an adapter to mount the EyeSafe™ unit on the faucet spout. Four adapters are furnished with the unit; a larger adapter with 15/16"-27 thread size to fit Delta and American Standard faucets, a small adapter with 13/16"-27 thread size to fit Kohler and other faucets, a 3/8" NPS adapter to fit WaterSaver faucets, and a 13/16"-24 thread size to fit Chicago Faucets. Important: When mounting EyeSafe to faucet, be careful not to overtighten the adapter.*

3. If necessary, use a 13/16" or adjustable wrench to adjust the angle of the outlet heads to obtain the desired angle for the eyewash water flow.
4. Attach the enclosed sign to wall or backsplash behind sink.

### Use

1. Turn on cold water side of faucet. *Important: Use only cold water when EyeSafe™ unit is in operation. Hot water may cause scalding or other injury.*
2. Pull knob on EyeSafe™ unit forward to activate the eyewash. Water pressure will hold the eyewash in operation, thus leaving the user's hands free.
3. To return to normal faucet operation, push knob back to original position.

*Note: When the faucet is turned off during eyewash activation, the pull-knob will return to original position automatically.*

### Maintenance

1. Periodic cleaning of the eyewash aerators is advisable to assure proper water flow.
2. Keep plastic float-off covers on outlet heads when the unit is not in use.
3. The EyeSafe™ unit, like all emergency eyewash and shower equipment, should be tested weekly.