



□ G1201 EyeSafe-X™ Faucet-Mounted Eyewash with Faucet Control Valve

Application: EyeSafe™ faucet-mounted eyewashes convert any faucet into an emergency eyewash station without interfering with normal faucet operation. An EyeSafe™ unit may be installed at any sink, close to where accidents might occur. In an emergency, the unit is quickly located and activated, and provides an unlimited supply of potable water for rinsing the user's eyes.

Operation: Unlike conventional faucet-mounted eyewashes, the G1201 offers the ability to activate the eyewash in a single motion. The unit is equipped with a diverter valve for the eyewash and a separate control valve for the faucet. Once the unit is installed on a faucet, the faucet may be opened and left "on" to a preset temperature. To use the faucet, the flow of water is controlled by a quarter-turn ball valve and knob at the bottom of the eyewash. To use the eyewash, simply pull the knob on the front of the eyewash. Since the faucet is open, this is the only step required to activate the eyewash. Water pressure holds the eyewash in operation, leaving the user's hands free. To return to normal faucet operation, push the knob in or turn off the faucet.

Outlet Heads: Outlet heads are mounted 5" apart and deliver a soft, aerated flow of water. Heads angle forward and inward toward user. Angle of heads is adjustable to permit full coverage and avoid splashing. Furnished with float-off dust covers to protect outlet heads.

Eyewash Valve: Forged brass diverter valve.

faucet control Valve: Quarter turn ball valve with chrome plated brass ball, molded TFE seals and plastic handle.

Inlet: Body has 55/64"-27 female thread. Furnished with four adapters (15/16"-27, 13/16"-27, 3/8" NPS and 13/16"-24) for installing on most commonly used faucets, including laboratory-type faucets.

Outlet: Furnished with removable aerator on bottom.

Quality Assurance: Each unit is completely assembled and water tested prior to shipment.

Available Options

- **250-046R** Replacement float-off dust covers (package of 2).



IMPORTANT: Faucet-mounted eyewashes are intended solely as supplemental units in addition to dedicated, plumbed eyewash equipment installed in the workplace.

Faucet-mounted eyewashes should be used with cold or warm water only. Use of hot water might cause scalding.

Leaving a faucet "on" with a valve at the outlet closed can cause cross-mixing of the hot and cold water. The water supply lines or the faucet should be furnished with check valves to prevent such mixing from occurring. This unit should not be installed on a faucet with an atmospheric vacuum breaker, as the faucet control valve downstream of the vacuum breaker will interfere with its function. Guardian Equipment recommends consulting with local plumbing code authorities prior to installing this unit.



□ G1201 EyeSafe-X™ Faucet-Mounted Eyewash with Faucet Control Valve

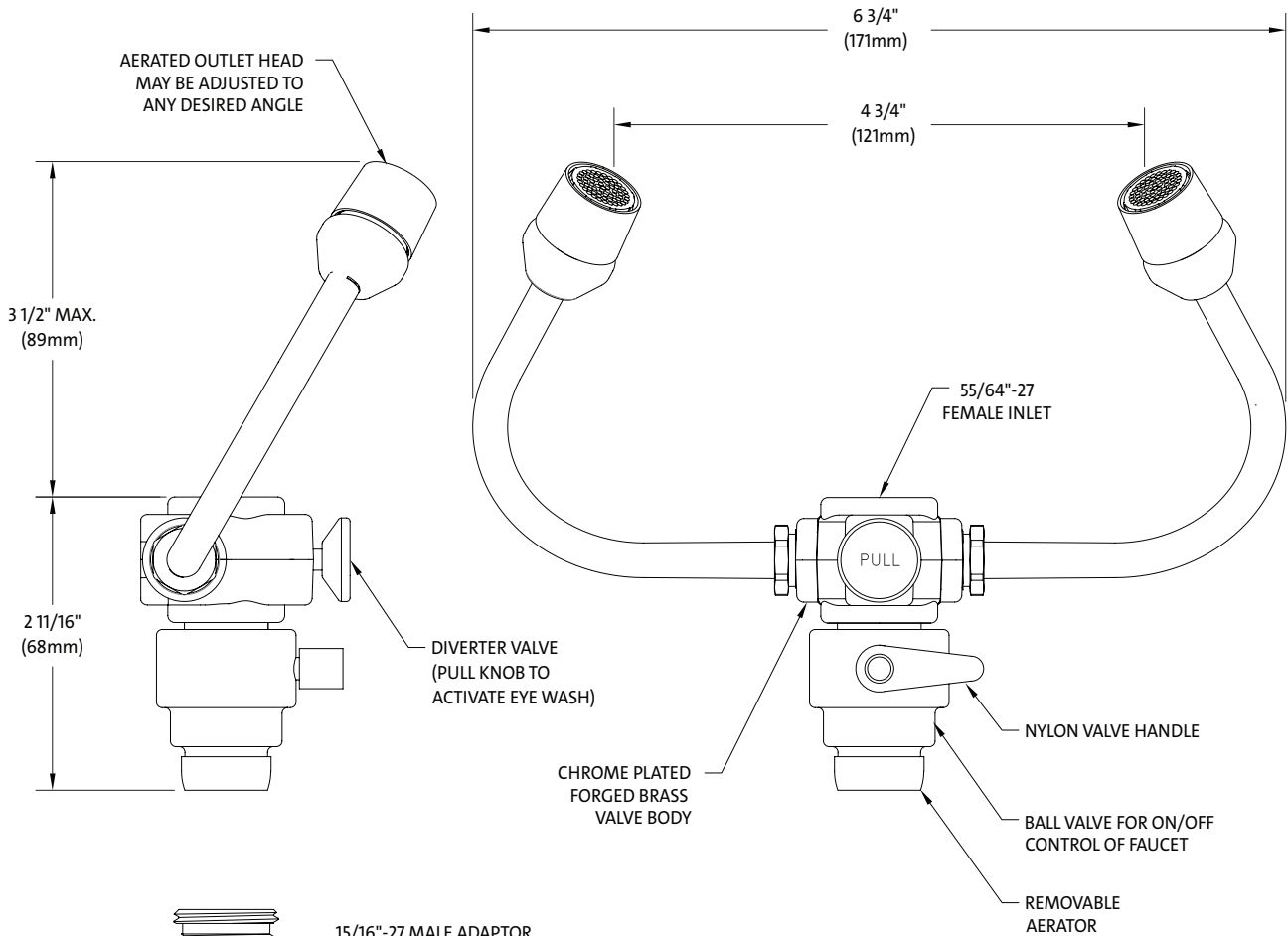

15/16"-27 MALE ADAPTOR



13/16"-27 MALE ADAPTOR



3/8" NPS MALE ADAPTOR



13/16"-24 FEMALE ADAPTOR

NOTES:

1. USE COLD OR WARM WATER ONLY WITH FAUCET-MOUNTED EYE WASH.
2. THIS UNIT IS INTENDED AS A SUPPLEMENT TO, BUT NOT A REPLACEMENT FOR, DEDICATED PLUMBED-IN EYE WASH EQUIPMENT.

UNITS (EXCEPT THOSE WITH SELF-CLOSING VALVES) COMPLY WITH THE REQUIREMENTS OF ANSI Z358.1.

TEST ALL EMERGENCY EQUIPMENT AT LEAST WEEKLY.

THIS SPACE FOR ARCHITECT/ENGINEER APPROVAL

Due to continuing product improvement, the information contained in this document is subject to change without notice. All dimensions are ± 1/4" (6mm). rev. 060823

Sign Included

